

**APPENDIX B**

**REQUIRED DOCUMENTATION**

Arizona Agribusiness & Equine Center Inc.

AAEC Corporate Board Meeting Minutes 11.22.2017 9:10 AM AAEC District Offices

3636 N Central AVE Suite 1050 Phoenix Arizona 85012 (Teleconference)

Regular Meeting: Notices of this meeting have been appropriately posted by A.R.S. 38-731-02  
078510000, 078993000, 078707000 and 078587000 and 138785000

- I. Call to order at 9:10 AM
- II. Roll Call: Linda Proctor Downing Corporate Board Member President, Pamela Burns Corporate Board Member Secretary, Irene V. Rassi Corporate Board Member.
- III. Approval of Agenda: Irene V. Rassi made a motion to adopt the 11.22.2017 Corporate Board Agenda. Pam Burns seconded the motion, the motion carried.
- IV. Public Participation: There were no members of the general public at the 11.22.2017 Corporate Board Meeting. Irene V. Rassi made a motion to table Public Participation, Pam Burns seconded the motion, the item was tabled.
- V. Enrollment cap increase for charter AAEC South Mountain #078993000, Pam Burns made a motion to increase the charter school enrollment cap from 450 to 500 students, Irene V. Rassi seconded the motion, the motion carried.
- VI. Increase calendar days for all AAEC campuses: Irene V. Rassi made a motion to increase the calendar days from 180 days to 183 days, Pam Burns seconded the motion, the motion carried.
- VII. Adjournment: Pam Burns made a motion to adjourn the Board meeting at 9:15 AM, Irene V. rassi seconded the motion, the motion carried. The meeting adjourned at 9:15 AM.



City of Phoenix

# CERTIFICATE OF OCCUPANCY

**MAIL TO:**

MTV GENERAL CONTRACTORS INC.  
2840 N NORWALK STREET  
MESA, AZ 85215

Issuance of this Certificate of Occupancy indicates the following described building, or portion of a building, has been inspected and been found to be in substantial compliance with applicable city codes and ordinances for the hereby authorized use and occupancy. No change in use, occupancy, or of use is allowed without obtaining a new Certificate of Occupancy. This building shall be maintained in a safe and sanitary condition. All devices, safeguards and exit facilities shall be maintained in good working order. This Certificate of Occupancy shall be void if any requirement, condition or stipulation of Certificate of Occupancy or of the authorizing permits is violated. This Certificate of Occupancy is to be kept on the subject property, and is required to be posted for public information if so ordered by the building official.

**SUBJECT ADDRESS:** 1924 E BASELINE RD  
**OWNER:**

**CERTIFICATE #:** 0608636                      **BUILDING PERMIT:** BLD 05030297  
**ISSUED:** 20-JUL-2006                      **PERMIT DESC:** AZ AGRIBUSINESS & EQUINE CTR CHART  
**PROJECT:** 04-3308 - ARIZONA AGRIBUSINESS & EQUINE CENTER

**FLOOR AREA:** 15,000

**AUTHORIZED USE AND OCCUPANCY:** B/E-1

phrp0101 rev 1.1 kl

EFFECTIVE BUILDING CODES: 1997 UBC, 1994 UPC STATE, 2000 UMC, 1999 NEC, 1997 UFC

PROJECT NAME: AZ AGRIBUSINESS & EQUINE CENTER LOG#:LPRN 0501179 PROJECT#:04-3308 SITE INSP (Y) SPECIAL  
EGRESS CONTROL (N)

SPRINKLERS (Y) FIRE ALARM (Y) EMERGENCY LIGHTING (Y) ELEVATORS (N)

DEFERRED SUBMITTAL (Y): WOOD TRUSSES

SPEC PER PCC SEC. 1701 (Y): SPECIAL GRADING, EXCAVATION AND FILLING, CONCRETE, BOLTS INSTALLED IN CONCRETE,  
REINFORCING STEEL, STRUCTURAL WELDING, STRUCTURAL MASONRY, EXPANSION/EPOXY ANCHORS.

STR SEC. 1702 (N)

ELEC PCC SEC. 2702 (N) ELEC OBS PCC SEC. 2703 (N)

WATER METERS:Two 2" domestic water meters, One 1" landscape water meter SECONDARY BACKFLOW (Y)

SCOPE OF WORK: BLDG PLMB MECH ELEC STRUC LSC SITE CIVIL PCD

ZONING:R1-14

REVIEWER: SJAB

DESCRIPTION OF WORK: A NEW ONE STORY CHARTER HIGH SCHOOL WITH CIVIL, LANDSCAPING, ARCHITECTURAL, MECHANICAL,  
PLUMBING, AND ELECTRICAL WORK.

SM



**Department of Forestry  
and Fire Management  
Office of the State Fire Marshal**



**ARIZONA STATE FIRE MARSHAL - Thursday, April 06, 2017 11:18:12 AM (Anthony Shamblen)**

User Name	Anthony Shamblen	
User #	6027620619	
Form Started	4/6/2017 11:18:12 AM	
Form Submitted	4/6/2017 11:54:12 AM	
Inspection Date	Thursday, April 06, 2017	
OSFM Facility ID	13596	
Occupancy Classification	E	
Ownership	Public Property	
Property Usage	School	
School Type	High School	
Fire Alarm Coverage	Full Coverage	
Fire Alarm System	Yes	
Monitored		
Fire Sprinkler Coverage	Full Sprinkler Coverage	
Facility Name	ARIZONA AGRIBUSINESS & EQUINE CENTER	
Facility Address	2002 EAST BASELINE	
City	PHOENIX	
County	Maricopa	
Contact for Inspection	VIRGINIA TORRES	
Contact Phone Number	6023239890	
Fire Marshal Contact	Arizona State Fire Marshal's Office Suite 100 Phoenix, Arizona 85007	1110 West Washington St. (O) 602.364.1003
DEPUTY FIRE MARSHAL:	Anthony Shamblen 84	

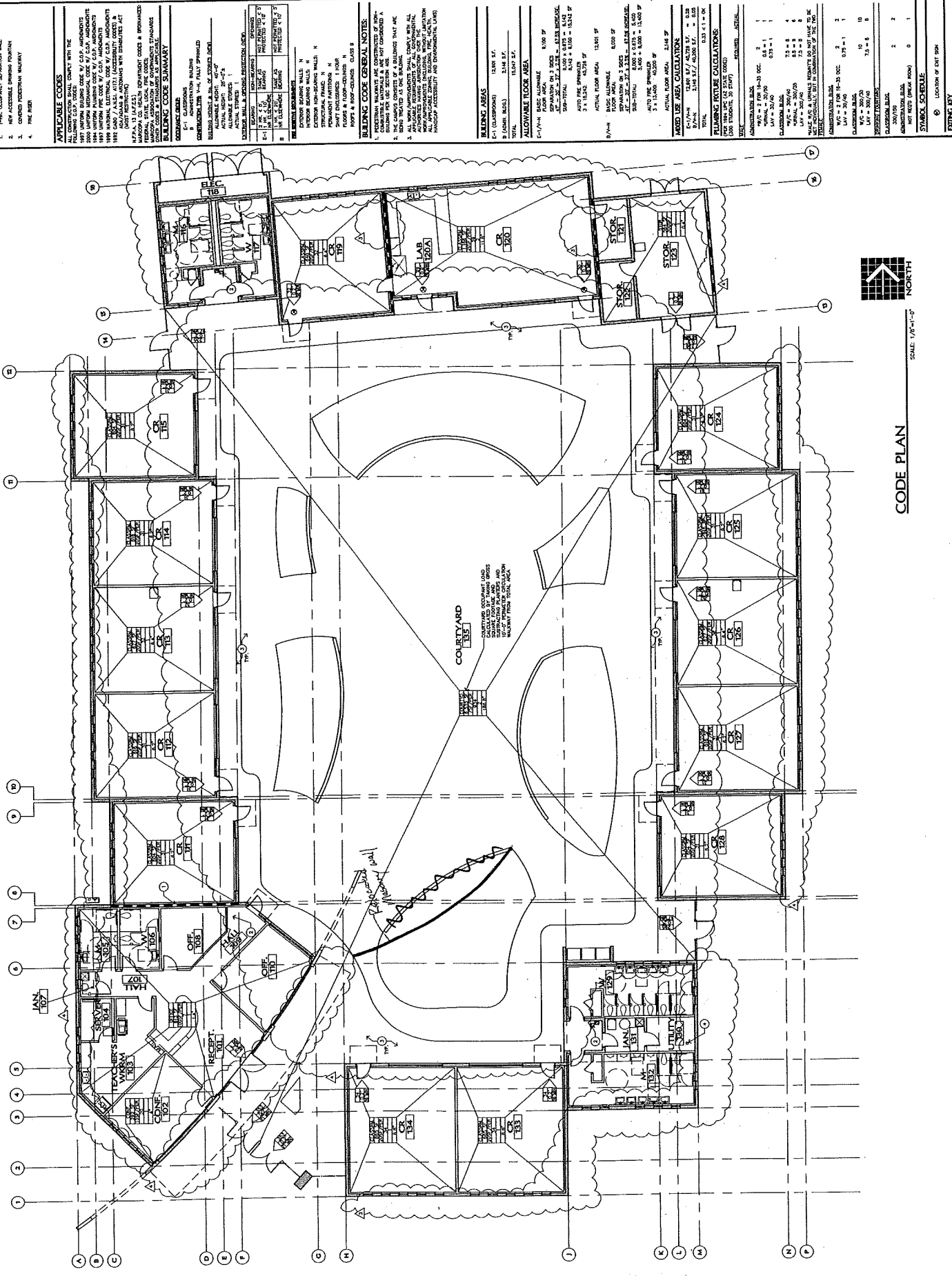

**KEYNOTES:**

1. THE OCCUPANT SEPARATION WALL
2. NEW ACCESSIBLE ENTRANCE PORTAL
3. COVERED FOOTCUREN MAINTENANCE
4. FIRE ESCAPE

**APPLICABLE CODES:**

ALL CONSTRUCTION SHALL COMPLY WITH THE FOLLOWING CODES:

- 2006 International Building Code (IBC) - ALL
- 2006 International Mechanical Code (IMC) - ALL
- 2006 International Electrical Code (IEC) - ALL
- 2006 International Fire Code (IFC) - ALL
- 2006 International Fuel Gas Code (IFGC) - ALL
- 2006 International Plumbing Code (IPC) - ALL
- 2006 International Mechanical Code (IMC) - ALL
- 2006 International Electrical Code (IEC) - ALL
- 2006 International Fire Code (IFC) - ALL
- 2006 International Fuel Gas Code (IFGC) - ALL

**ADMINISTRATIVE BUILDING:**

- W/C = 2 FOR 18-20 OCC.
- LAV = 20/75
- CLUBROOMS: 5
- WATER: 2
- AV = 200/75
- LAV = 200/75
- CLUBROOMS: 5
- WATER: 2
- AV = 200/75

**LABORATORY:**

- W/C = 2 FOR 18-20 OCC.
- LAV = 20/75
- CLUBROOMS: 5
- WATER: 2
- AV = 200/75
- LAV = 200/75
- CLUBROOMS: 5
- WATER: 2
- AV = 200/75

**SHOP:**

- W/C = 2 FOR 18-20 OCC.
- LAV = 20/75
- CLUBROOMS: 5
- WATER: 2
- AV = 200/75
- LAV = 200/75
- CLUBROOMS: 5
- WATER: 2
- AV = 200/75

**PLUMBING PITCH CALCULATIONS:**

W/C = 2 FOR 18-20 OCC. = 0.03  
 LAV = 20/75 = 0.03  
 TOTAL = 0.03 @ 1" = 0"

**EXISTING KEY:**

- 1. EXISTING EQUIPMENT
- 2. EXISTING WALLS
- 3. EXISTING DOORS
- 4. EXISTING WINDOWS
- 5. EXISTING FLOOR FINISH
- 6. EXISTING CEILING FINISH
- 7. EXISTING ROOF FINISH
- 8. EXISTING UTILITY
- 9. EXISTING MECHANICAL
- 10. EXISTING ELECTRICAL
- 11. EXISTING PLUMBING
- 12. EXISTING STRUCTURE



SCALE: 1/8"=1'-0"  
**CODE PLAN**